

HORSEPOWER RATED

HEAVY CURRENT TIMING RELAY

LOW COST OPEN CONSTRUCTION

30 AMPERE CONTACTS 2HP RATED

Series 683E - INTERVAL ON

- Environment Protected
- Sealed Relay
- No False Operate
- Switches 3600W @120V, 7200W @ 240V
- SPDT Relay Output
- Small Size – 3.625" x 2.125" x 1 9/16"
- Lightweight – approximately 3 oz.
- CMOS Digital Circuitry
- Transient Protected to 6000V
- 30 Amp Resistive. Load Rating

Application of power simultaneously starts timing of the preset interval and turns the load ON. At the end of the timed period the N/O load contact opens, turning OFF the load. Power to the timer must be applied continuously throughout the time period. Removal of power causes the timer to reset to T = 0. A new cycle can start by re-application of input voltage.

Control the timing of high power electric heaters, HP Rated motors, lamps, transformers and other high current loads rated less than 30 amps Resistive. CMOS digital circuitry is combined with a heavy current relay rated at 30 amps. P/C board and components are covered with a moisture resistant coating. Wiring Terminals are ¼ quick connect. Available in all standard voltages and frequencies. Fixed or adjustable timing from .1 seconds to 24 hours.

TIMING DIAGRAM



SPECIFICATIONS

1. Repeat Accuracy: $\pm 0.25\%$
2. Combined Effect of Temperature and Voltage upon Repeat Accuracy: $\pm 2\%$
3. Reset Time: 150 ms.
4. Operating Voltage Tolerance: $\pm 20\%$
5. Load Current: Steady State – 30 Amps General Purpose At 120/240 VAC, or 30VDC, 1 HP@120VAC, 2HP@
6. Dielectric Strength: 1500 VRMS
7. Insulation Resistance: 100 Megohms Min.
8. Input Transient Protection: 3000V 120V UNITS, 6000V 240V units
9. Temperature Ambients: Operating -40°C to $+70^{\circ}\text{C}$ Storage -55°C to $+70^{\circ}\text{C}$
10. Humidity-Operating: 95% Relative
11. Linearity(Option A or D): $\pm 5\%$ Minimum from 10% to 90% of range
12. Timing Tolerance: $\pm 9\%$ + Tolerance of Rt Std., $\pm 5\%$ Special (Fixed)

HOW TO ORDER 683E – (T) (V) (P)

| SERIES | (T) = TIME RANGE | (V)=VOLTAGE | (P) = OPTIONS |
|-------------|--|--|--|
| 683E | P = 0.1 - 5 SEC. 1 = 0.1 - 10 SEC. L = 0.2 - 20 SEC. J = 0.3 - 30 SEC. M = 0.6 - 60 SEC. 2 = 1 - 100 SEC. K = 1.2 - 120 SEC. F = 2 - 180 SEC. E = 3 - 300 SEC. 3 = 10 - 1000 SEC. 4 = 0.1 - 10 MIN. G = 0.3 - 30 MIN. H = 0.6 - 60 MIN. 5 = 1 - 100 MIN. V = 3 - 300 MIN. 6 = 10 - 1000 MIN. D = 1 - 24 HRS. | 1 = 12VDC 2 = 24VDC 3 = 48VDC 4 = 24VAC 5 = 120VAC 6 = 240VAC 7 = 115VDC | O - CUSTOMER SUPPLIES OWN POTENTIOMETER OR RESISTOR A - POTENTIOMETER SUPPLIED AS LOOSE PART *C - FACTORY FIXED INTERNAL D - TIME ADJUST POTENTIOMETER INSTALLED <div style="border: 1px solid black; padding: 5px; text-align: center; margin: 10px auto; width: fit-content;"> <i>* For Fixed Time Specify The Value In Seconds, Minutes, Or Hours</i> </div> <p style="text-align: right; font-weight: bold; margin-top: 20px;">MADE IN USA</p> |

EXAMPLE P/N: 683E-34D This is an INTERVAL 30A Rated Relay Output Solid State Timer with an adjustable 10 – 1000 second DELAY and an INPUT VOLTAGE of 24 VAC. The time adjust potentiometer is installed on board.

American Control Products / Precision Timer
 a division of Prime Technology
 344 Twin Lakes Road
 North Branford, CT 06471
 Telephone: (203) 481-5721
 Fax: (203) 481-8937
 Email: sales@primetechnology.com
 www.primetechnology.com



TECHNICAL BULLETIN

SOLID STATE TIMING MODULE

PAGE 1
OF 2

DATE
11-7-03

683E

REV

TYPICAL CALIBRATION RESISTANCE VS TIME

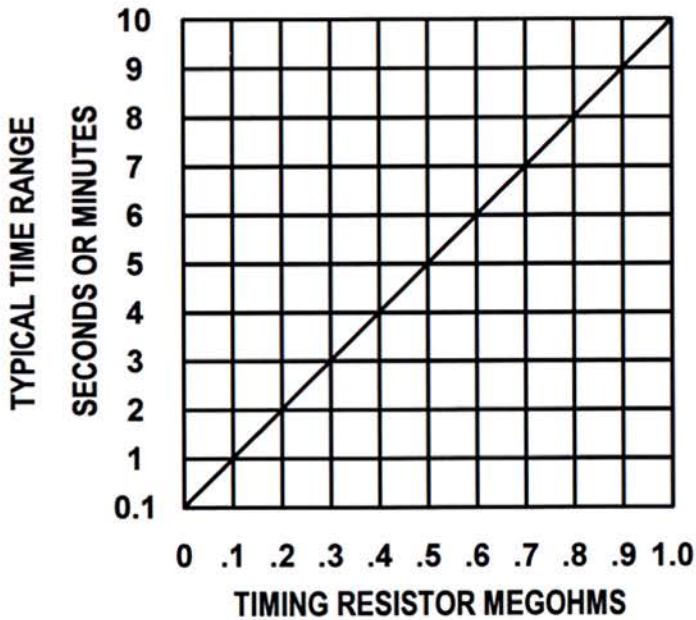

ACCESSORIES AVAILABLE FROM STOCK
CONTROL POTENTIOMETERS (OPTION A)
ORDER P/N PM-1M 1 MEGOHM ± 20%

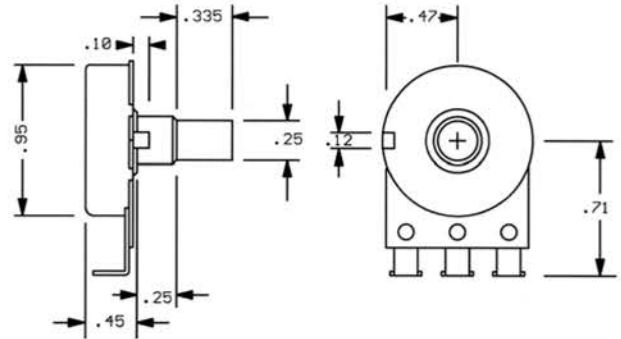

TYPICAL WIRING

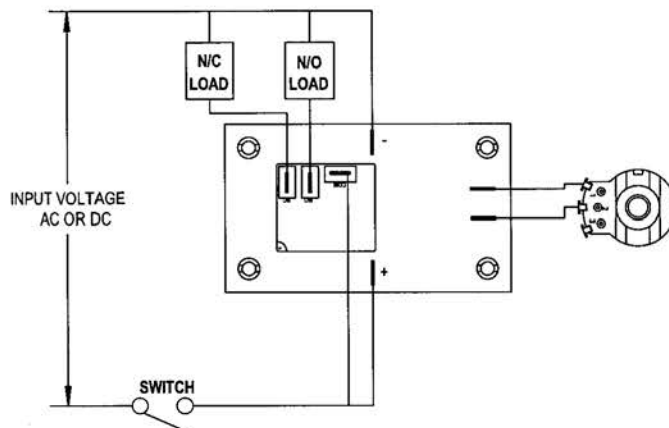

OUTLINE DRAWING

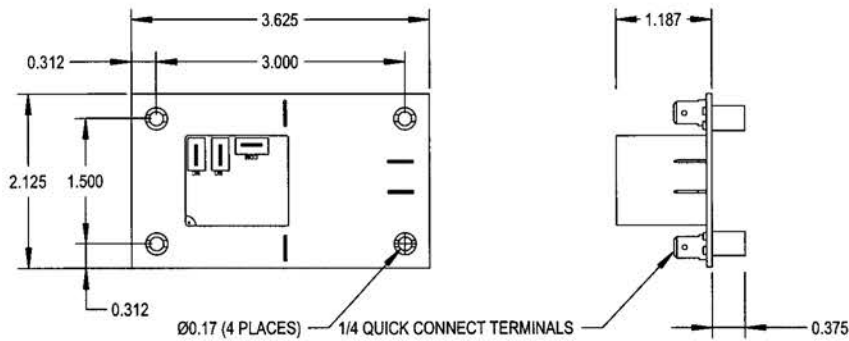

MADE IN USA

American Control Products / Precision Timer
 a division of Prime Technology
 344 Twin Lakes Road
 North Branford, CT 06471
 Telephone: (203) 481-5721
 Fax: (203) 481-8937
 Email: sales@primetechnology.com
 www.primetechnology.com



TECHNICAL BULLETIN

SOLID STATE TIMING MODULE

PAGE 2
OF 2

DATE
11-7-03

683E

REV